

## PARTS LIST

ITEM	PART #	QTY.	DESCRIPTION
1	206119	1	303 SS AP-2C HEAD ROLL-STAMP
2	300738	1	CV AP2 TL
3	201891	1	NIPPLE 3/8 MPT CLOSE 304SS
4	301154	2	AP-2 MAGNET/HOLDER ASSY
5	201518	1	POPPET EXHAUST SEAT LONG AP-2C
6	302902	1	AP2 LONG LEVERS ASSEMBLY
7	201871	3	SCREW 4-40 X 5/8 SKT HEAD 18-8
8	300455	1	SEAT INT AP2 ASSY
9	300456	1	TIKI AP2 ASSY
10	201887	2	NUT 4-40 NYLOCK 18-8SS
11	201705	1	SPRING EXTENSION LONG AP2
12	201886	1	PIN SPRING 3/32 DIA X 1/2 LG 18-8 SS
13	203358	1	AP-2C UPPER CONTROL ROD GUIDE
14	203359	1	AP-2C SPRING ANCHOR
15	300360	1	LONG AP-2C DISCHARGE TUBE ASSY
16	200701	2	O-RING PARKER 2-127 VITON V747-75
17	300362	1	LONG AP-2C CONTROL ROD ASSEMBLY
18	301229	2	FLOAT LONG AP-2 ASSY
19	201578	1	AP-2C CONTROL ROD GUIDE
20	201564	1	AP-2C BOTTOM SPRING PLUNGER
21	201718	1	SPRING BOTTOM COMPRESS AP2 LONG
22	201568	1	AP-2C BOTTOM SPRING CUP
23	201557	1	CASING LONG AP2 304SS
24	300406	1	SUPPORT/EYEB AP2 ASSY 304SS
25	300739	1	CV 3/8 MXF ASSY 303SS
26	201517	1	SCREEN AIR INTAK AP-2C 316 SS
27	206098	1	QUICK LINK 1/8 300 SERIES SS
28	42170	1	AP-2C TL BOTTOM PLUG
29	206290	1	PLUG, 1/4" 316SS COUNTERSUNK HEX

## EXPLODED VIEW OF LONG TOP-LOADING AP2 300418A

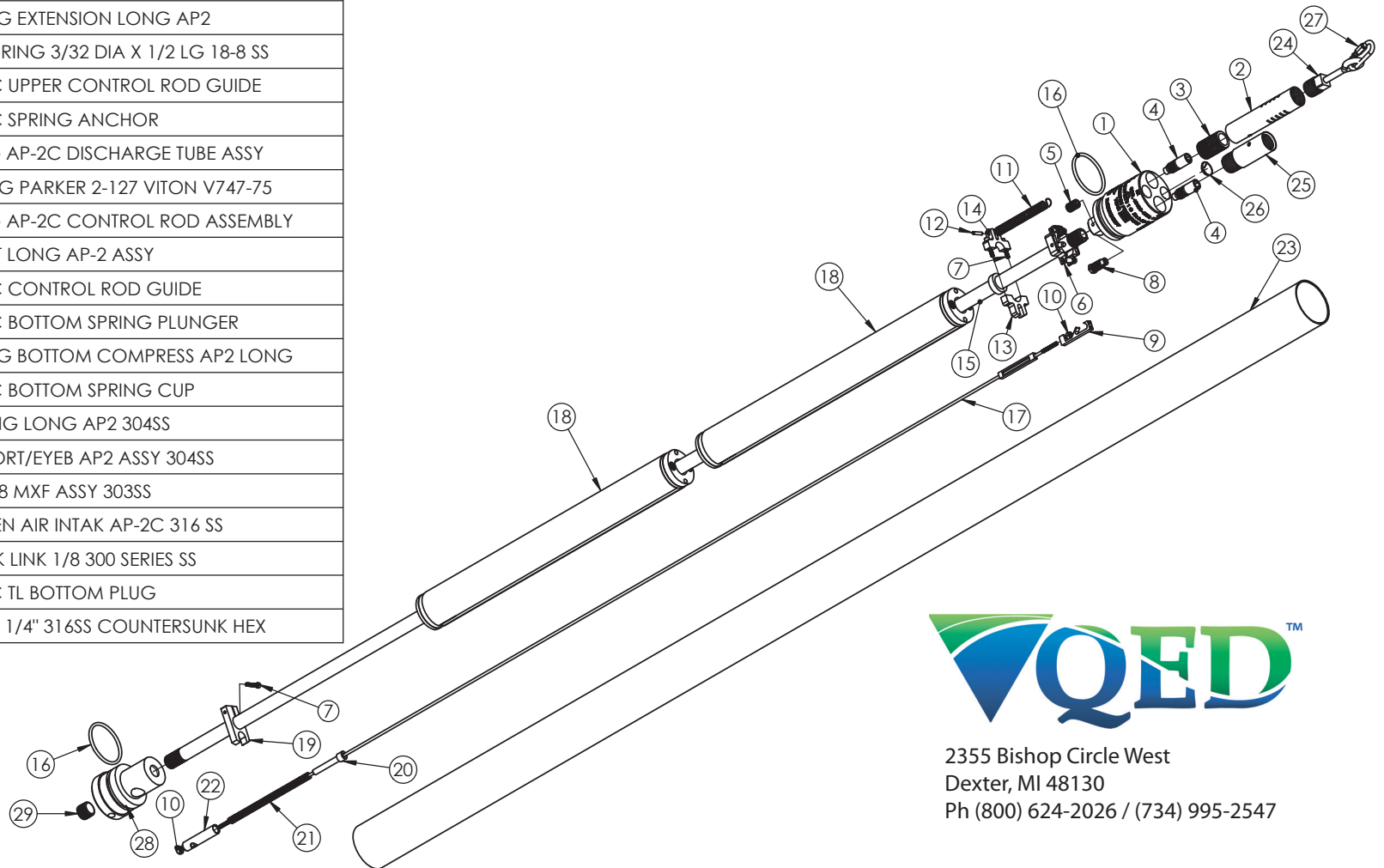

2355 Bishop Circle West  
Dexter, MI 48130  
Ph (800) 624-2026 / (734) 995-2547

**302902 - LEVER ASSEMBLY LONG AP2**

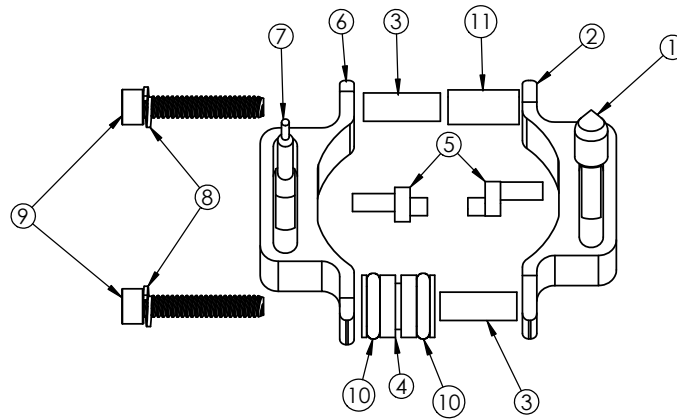

ITEM	PART #	QTY.	DESCRIPTION
1	201522	1	POPPET EXHAUST LONG AP-2C 304
2	201512	1	LEVER EXHAUST AP2 303SS
3	201514	2	SPACER AP2 LEVER 316SS
4	201513	1	SPACER AP2 LEVER 316SS
5	203740	2	PIN PIVOT AP2 NITRONIC 60
6	201498	1	LEVER INLET AP2 303SS
7	201519	1	POPPET AIR IN AP2 303SS
8	201632	2	S.S. LEVER SCREW LOCK WASHER
9	201871	2	SCREW 4-40 X 5/8 SKT HEAD 18-8
10	202100	2	O-RING PARKER 2-009 VITON V747-75
11	206023	1	TIKI ROLLER